



Manufacturers of High-Quality Farm Machinery

Parts Catalogue

Slurry Pump

Super 385



Hi-Spec Engineering Ltd.

Station Rd, Bagenalstown, Co. Carlow

Tel: +353 (0) 59-9721929 / 9721992

Fax: +353 (0) 59-9721980

Website: www.hispec.net

Hi-Spec Slurry Pumps

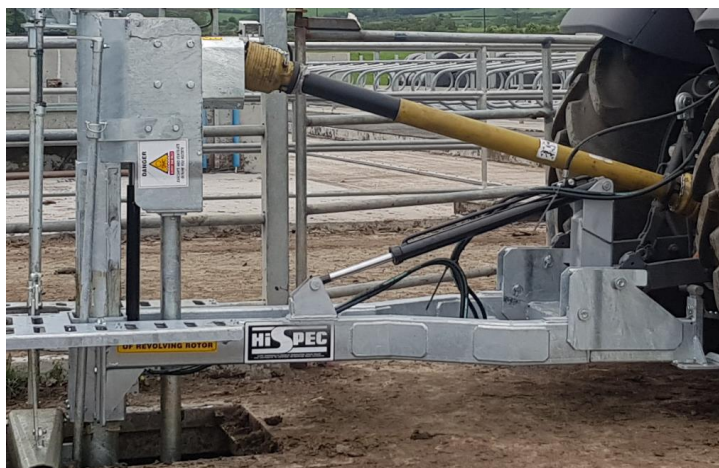

When ordering parts:

- Quote Machine Serial Number and Model.
- Quote the complete Part Number and Description.
- State the means by which you require delivery, whether by economy or priority
- Where reference is made to Left and Right, this should be understood to mean left or right when the machine is viewed from the rear.



NOTE:

- The illustrations in this book are for identification purposes only.
- Hi-Spec Engineering reserves the right to make changes or improvements at any time without incurring any obligation to make such changes on products sold previously.

Safety First:

Use only genuine Hi-Spec spare parts for this machine. Use of spare parts not supplied or recommended by Hi-Spec could result in injury to the operator or damage to the machine, and invalidate the warranty.

Table of contents

Contents

General Layout of Slurry Pumps.....	4
Gearbox assembly.....	5
Gearbox.....	6
Top Fill.....	8
Spout Direction Control.....	9
Linkage Frame.....	11
Splash plate angle control handle.....	12
Propeller.....	13
Safety Grid.....	14
PTO Shafts.....	15
Sales and Service.....	16

General Layout of Slurry Pumps

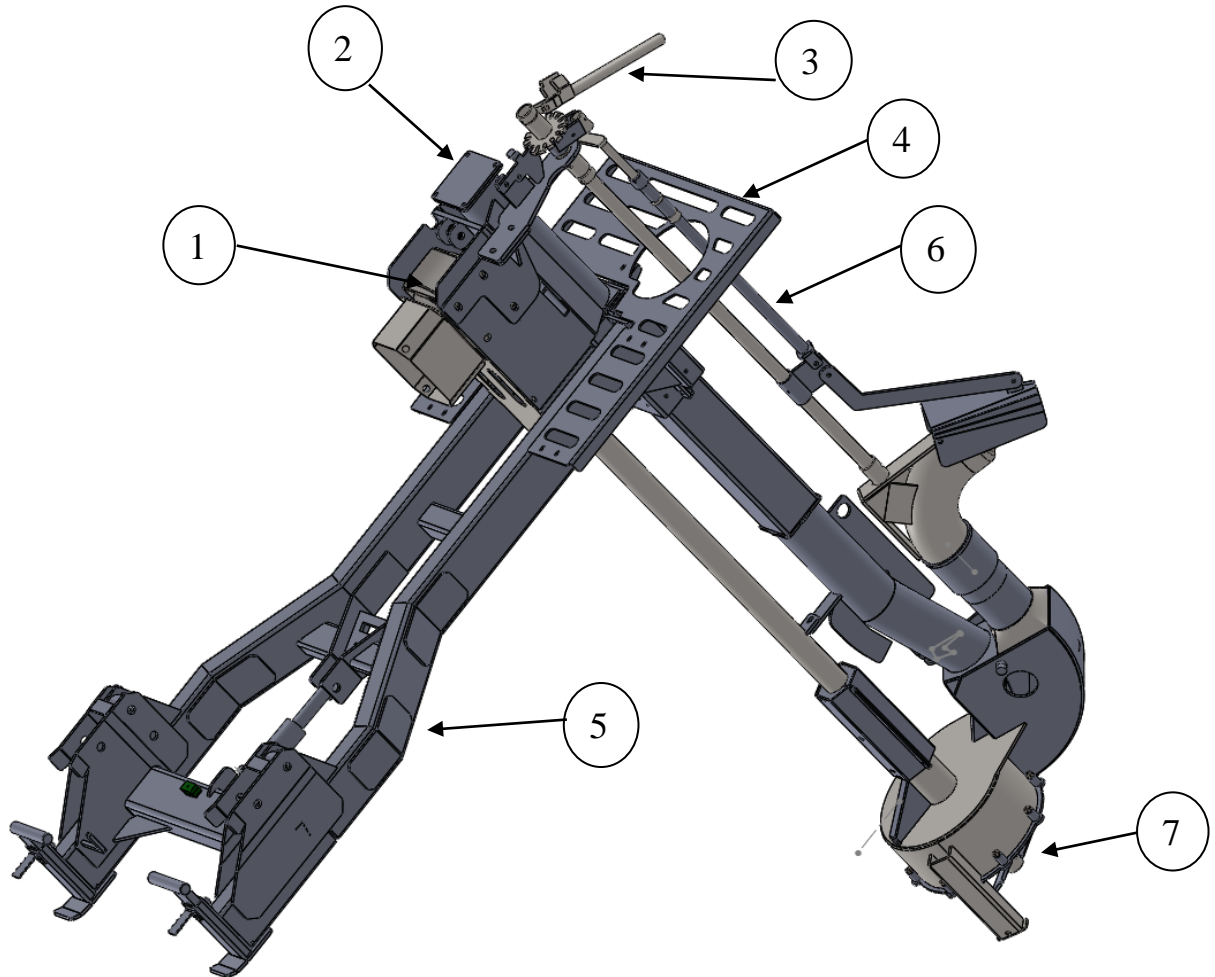

Reference	Description
1	Gearbox
2	Top fill (Optional)
3	Spout direction controls
4	Safety frame
5	Linkage frame
6	Spout angle control
7	Propeller

Gearbox assembly

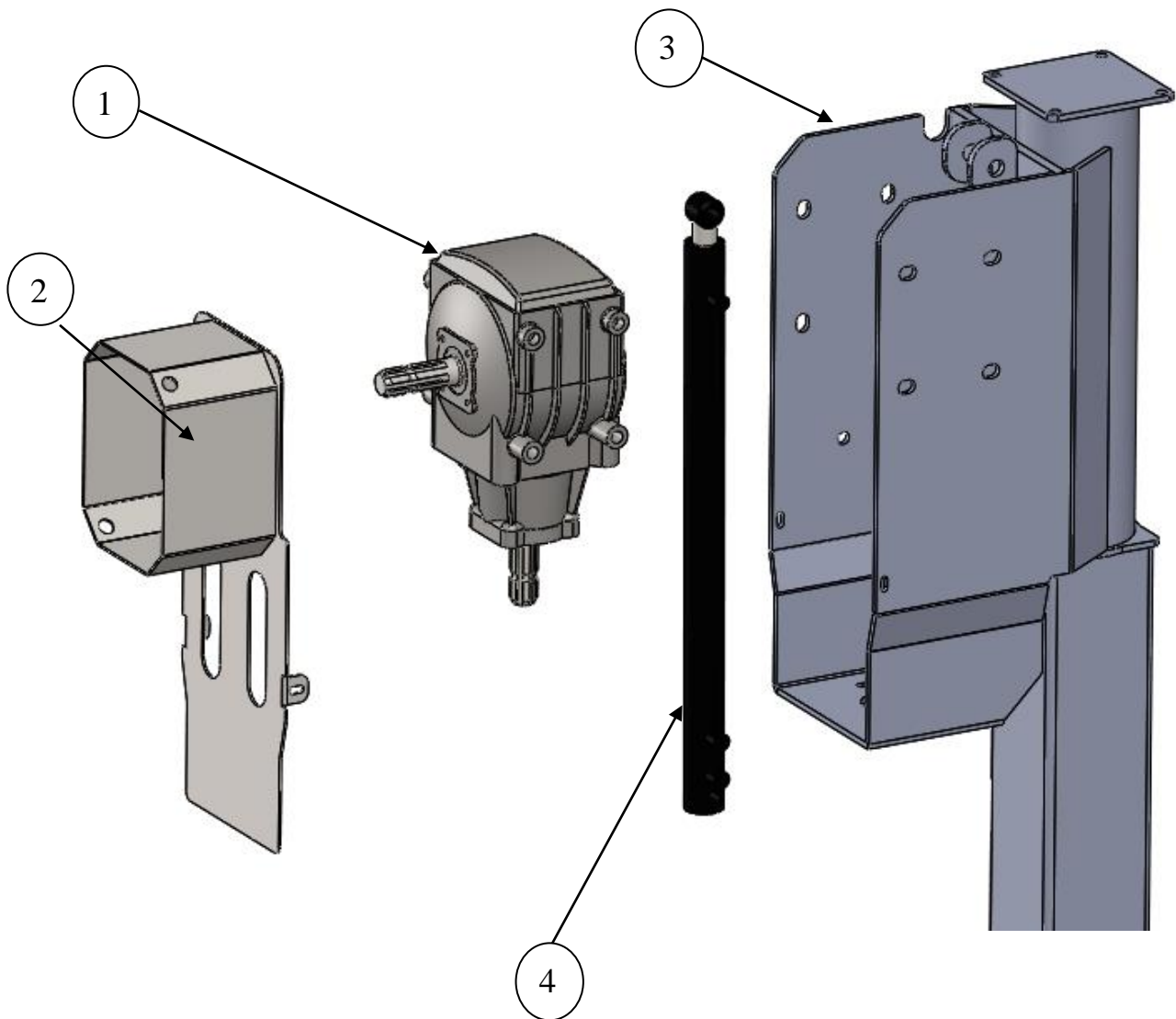

Part No.	Description
1	SP/T22A Gearbox (see page 6)
2	SP/0008 PTO Guard
3	Main Frame
4	Hydraulic Ram

Gearbox

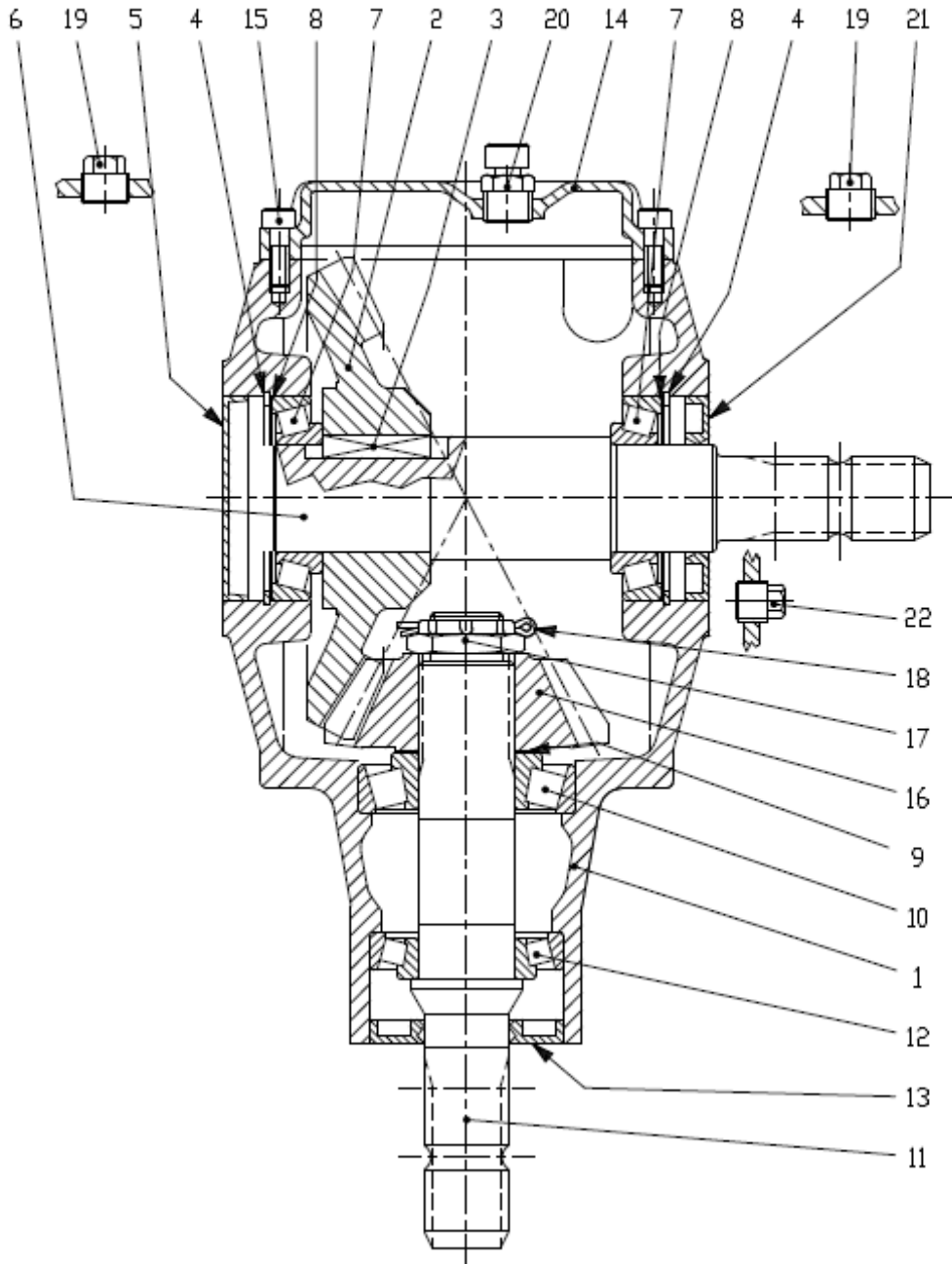

Recommended oil: SAE EP90

DESIGNATION	GEAR BOX	T-22A
-------------	----------	-------

CODE N°	9.262.058.00
---------	--------------

POS.	DRG. N.	PIEC	DESCRIPTION
1	0.262.0505.00	1	CASING
2	0.262.6000.00	1	CROWN WHEEL
3	8.4.1.00967	1	PARALLEL KEY
4	8.5.2.00332	2	SNAP RING
5	0.121.7101.00	1	CAP
6	0.262.3000.00	1	SHAFT
7	8.0.9.00143	2	BEARING
8	0.709.7500.00	2	SHIM
9	0.244.7500.00	1	SHIM KIT
10	8.0.9.00128	1	BEARING
11	0.262.2002.00	1	SHAFT
12	8.0.9.00024	1	BEARING
13	8.7.1.00315	1	DOUBLE LIP SEAL
14	0.262.1302.00	1	COVER
15	8.1.2.00197	6	BOLT
16	0.262.5000.00	1	PINION
17	0.132.7106.00	1	NUT
18	8.4.7.01111	1	COTTER PIN
19	8.6.5.00203	2	PLUG
20	8.6.7.00269	1	OIL FILLER PLUG
21	8.7.3.00331	1	OIL SEAL
22	8.6.5.00006	1	PLUG

Top Fill

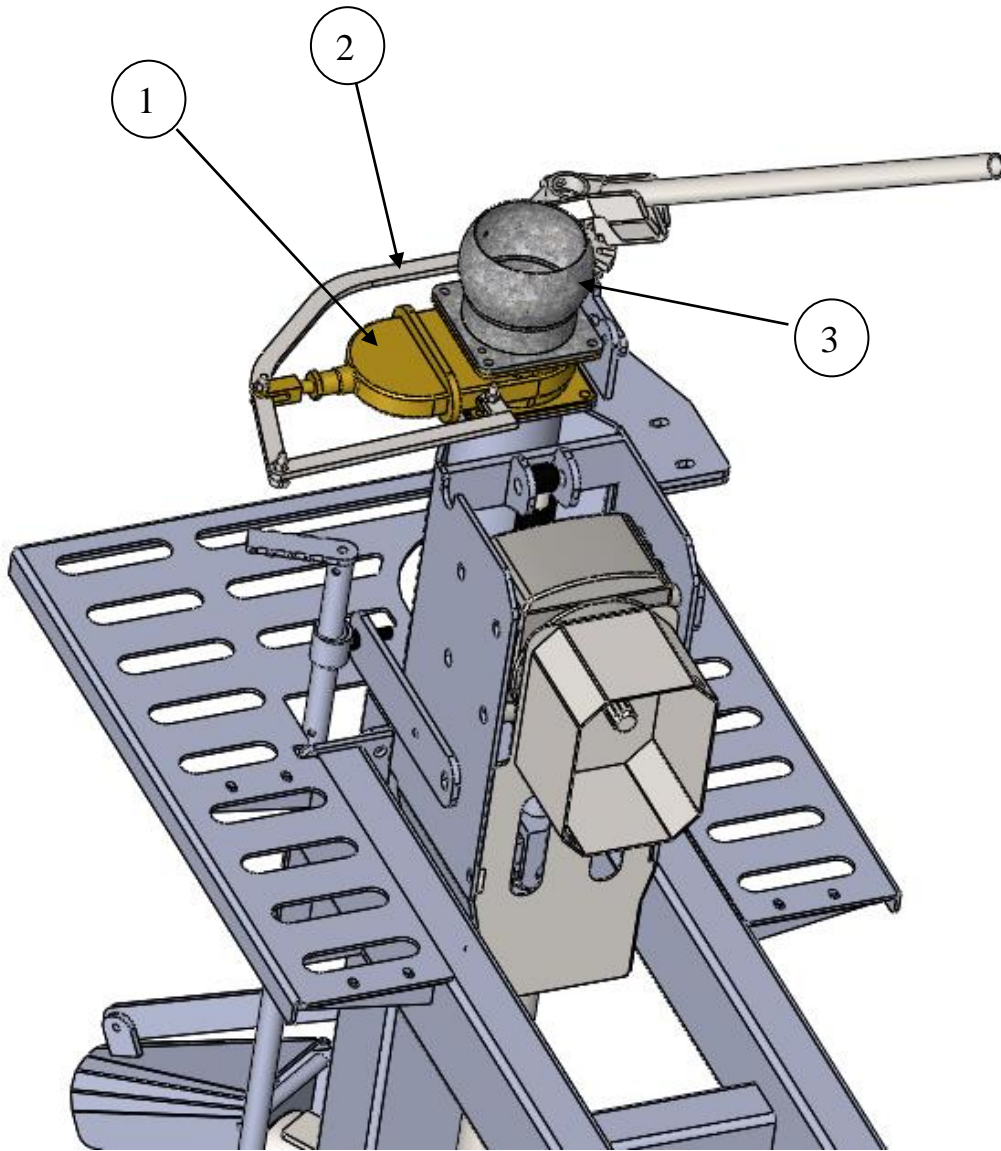

	Part No.	Description
1	VT/901	Double Flanged Gate Valve
	VT/318	6" Light Duty O-ring
2	VT/1100	Valve Handle
3	VT/1080	6" Male Coupling

Flow controller and handle

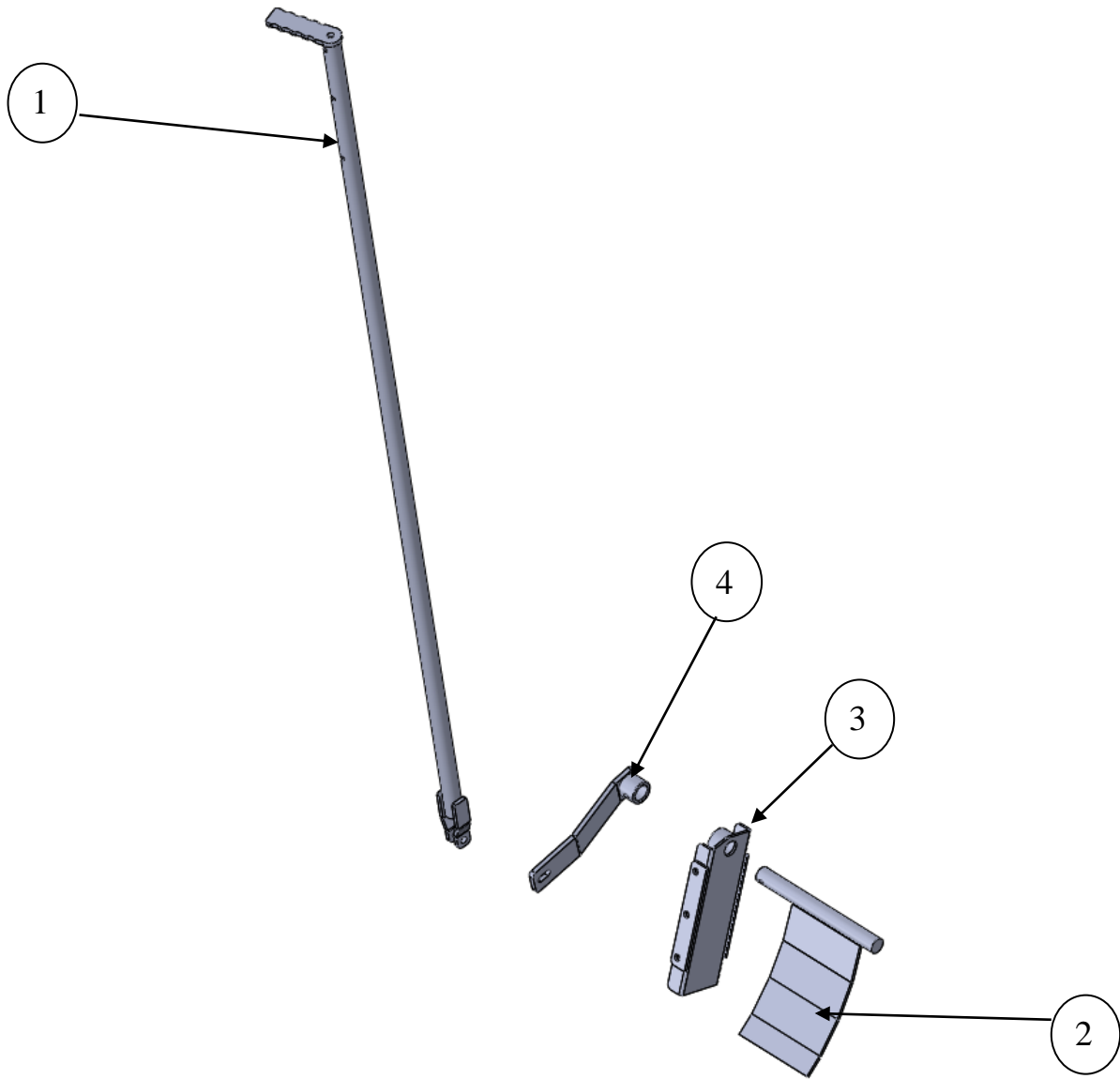

Part No.	<i>Description</i>
1	Flow diverter control handle
2	Flow divider
3	Divider Bracket
4	Divider lever

Spout Direction Control

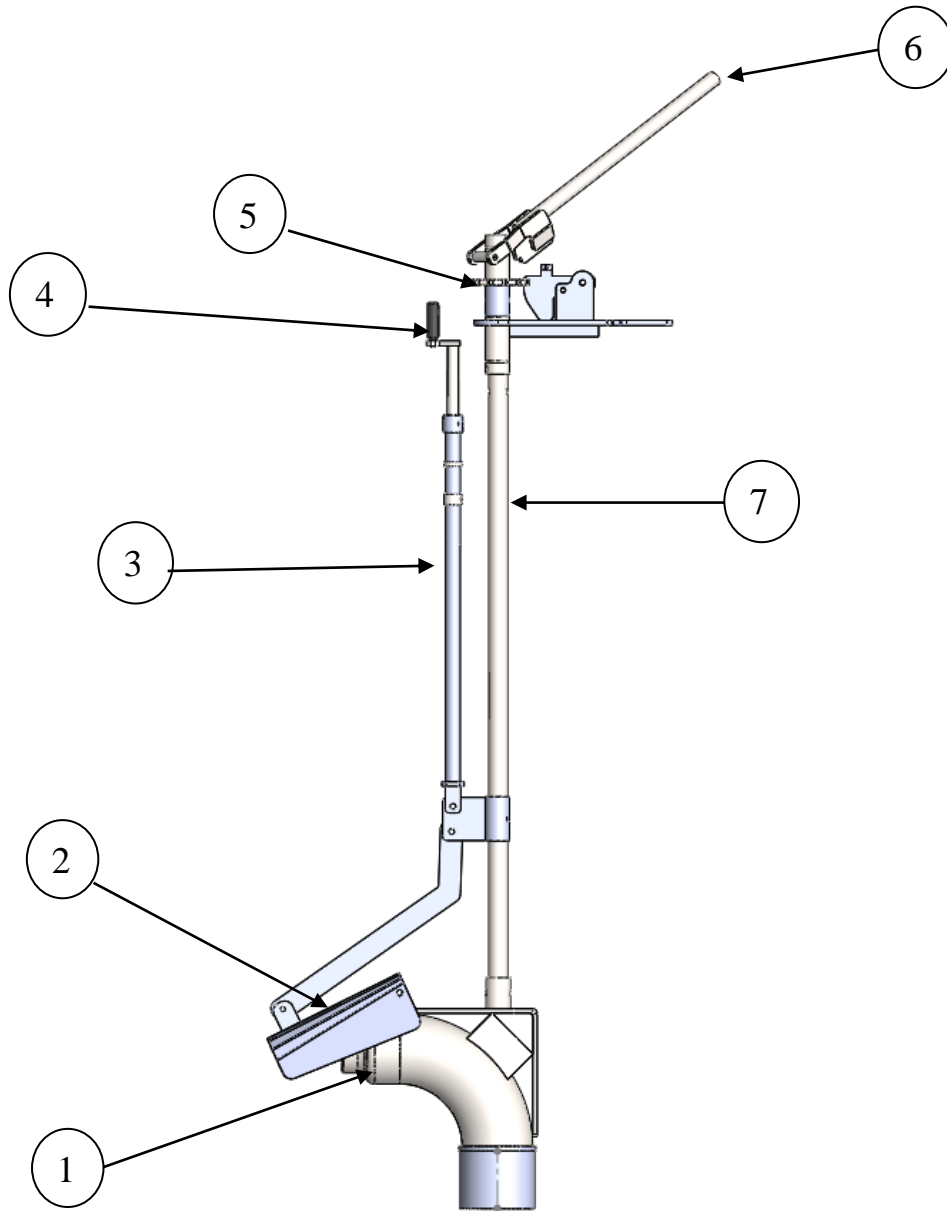

	Part No.	Description
1	SP/0006	Nozzle
2	SP/0022	Spout splash Plate
3	S/0015	Nozzle angle Adjustment bracket
4	SP/	Nozzle angle Adjustment Handle
5	SP/	Locking star
6	SP/	Adjustment Arm
7	SP	Direction Adjustment Arm

Linkage Frame

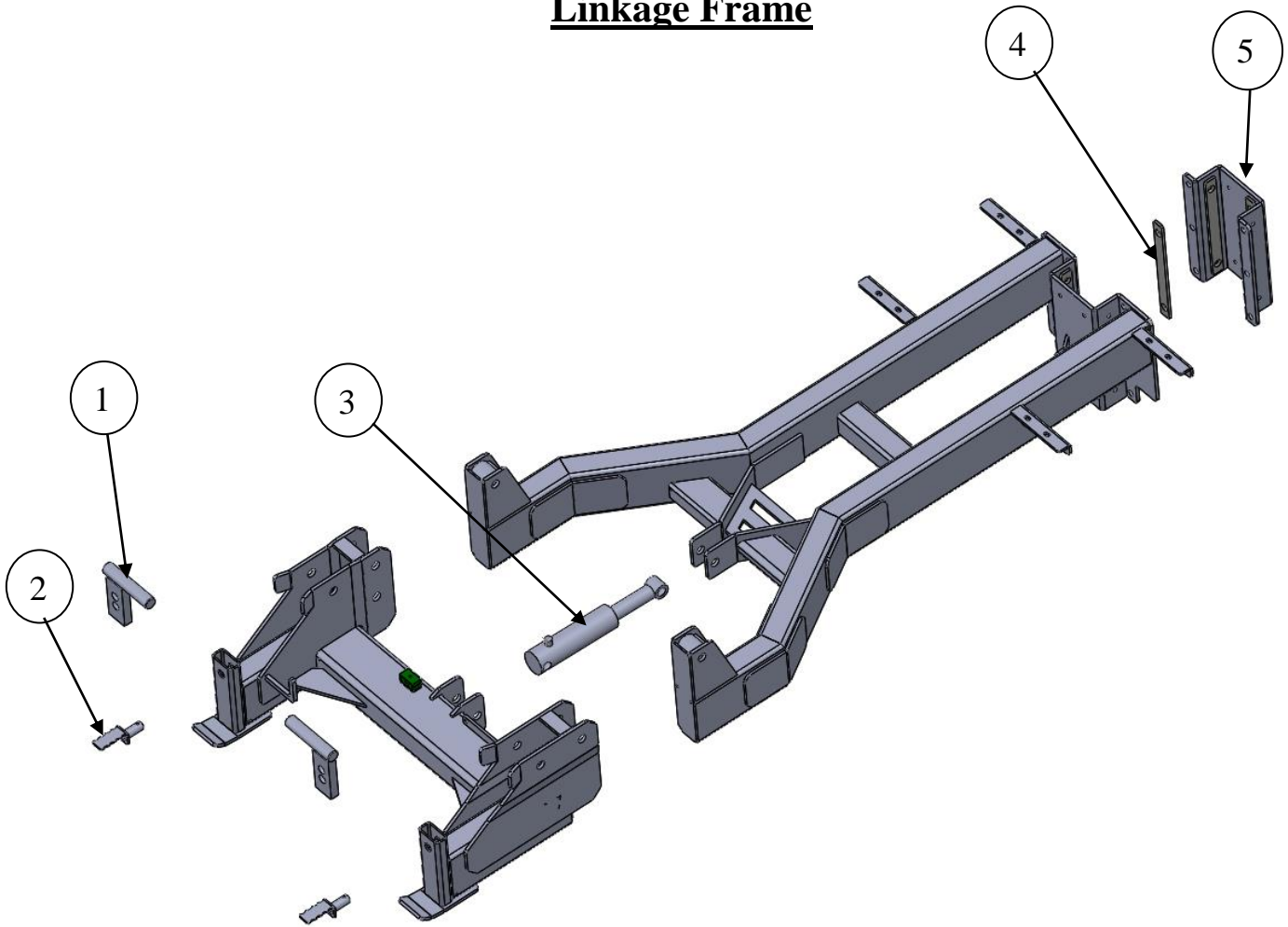

Part No.	<i>Description</i>
1	Height Adjuster
2	Pin
3	Hydraulic Ram
4	Nylon Slider
5	Outside Slider Bracket

Nozzle angle control handle

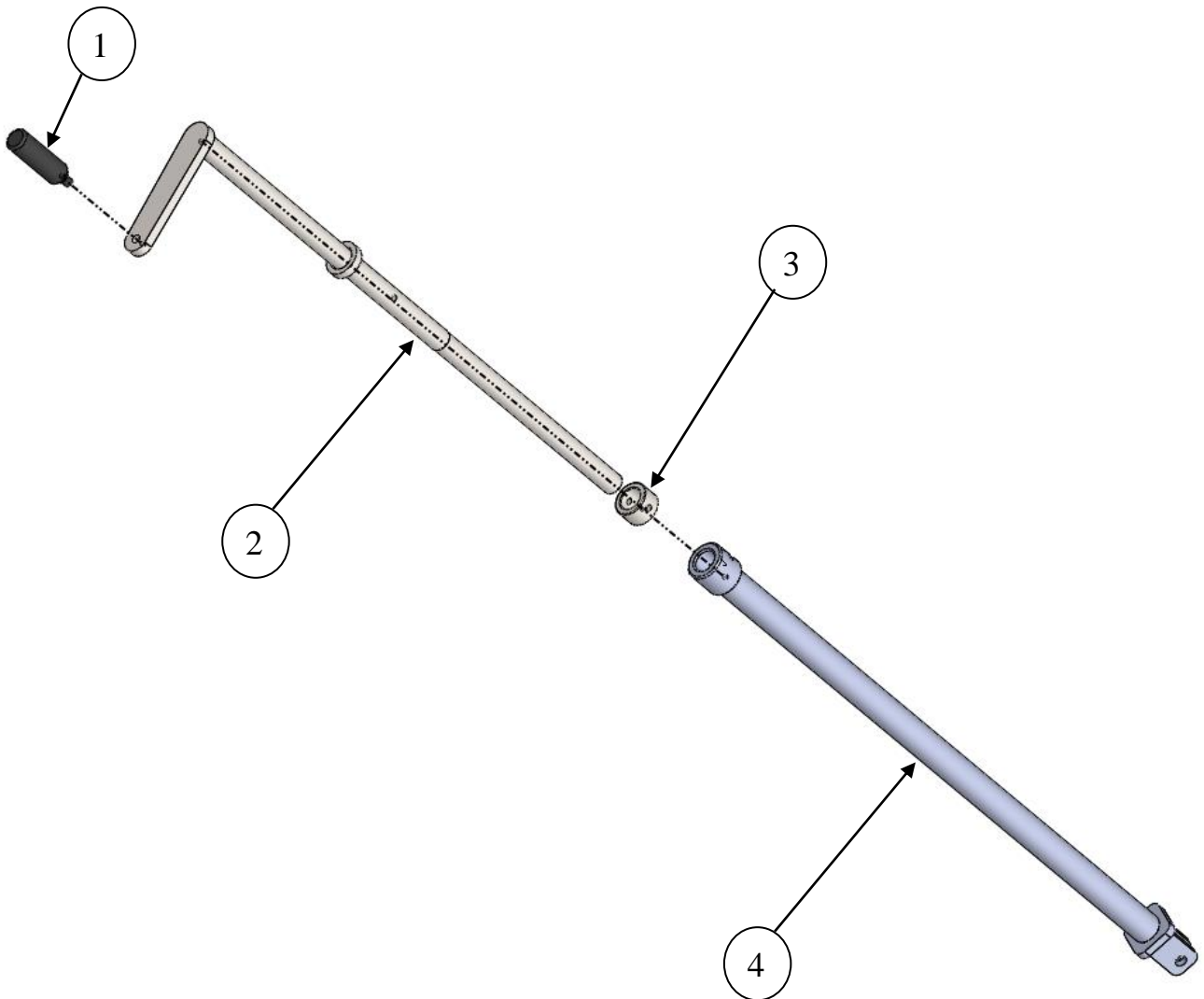

<i>Part No.</i>	<i>Description</i>
1	Threaded Handle
2	Shaft (one piece)
3	Collar
	Nozzle control bracket

Propeller

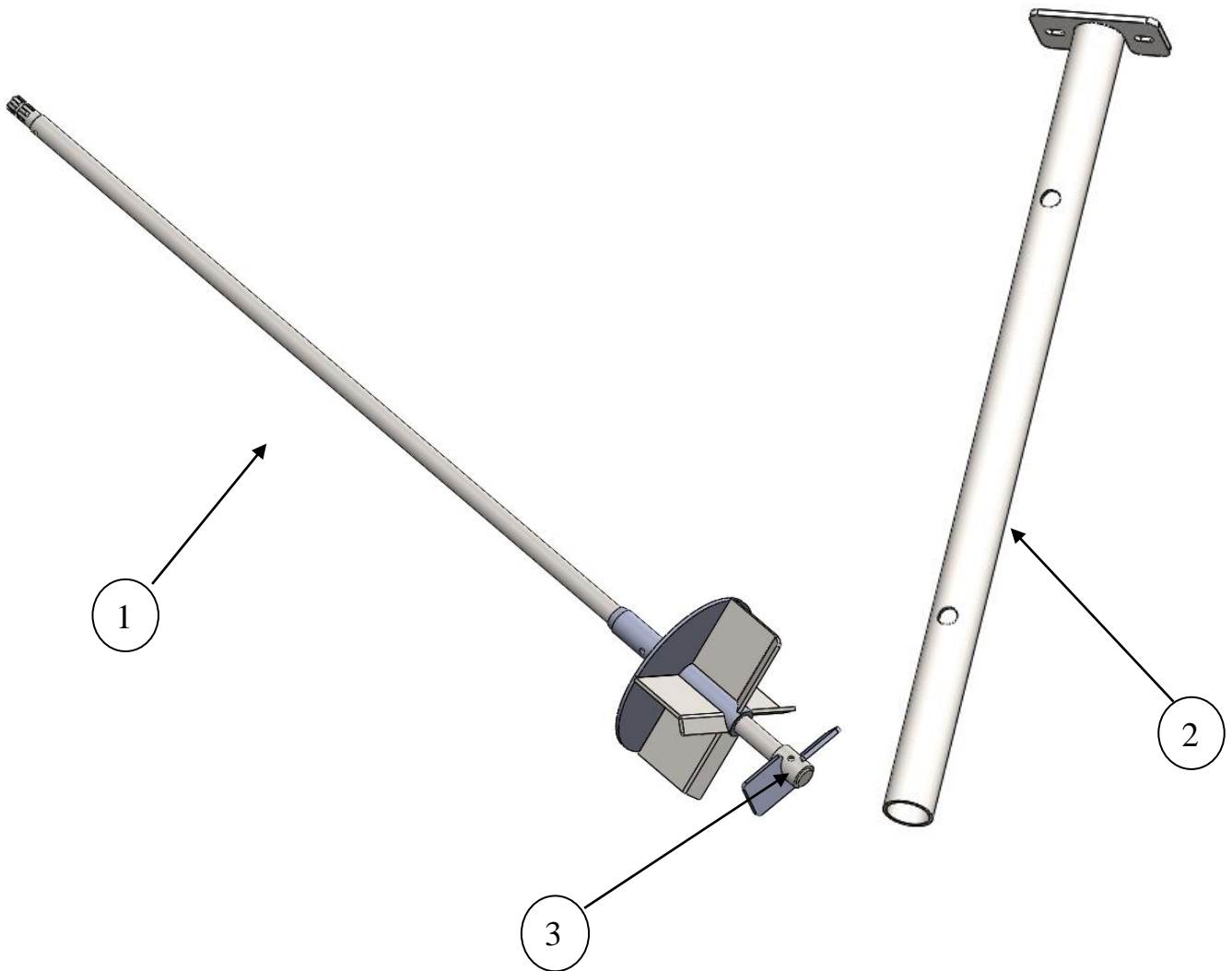

Part No.	Description
1	Propeller & Shaft
2	Shaft Cover
3	Whisk

Safety Grid

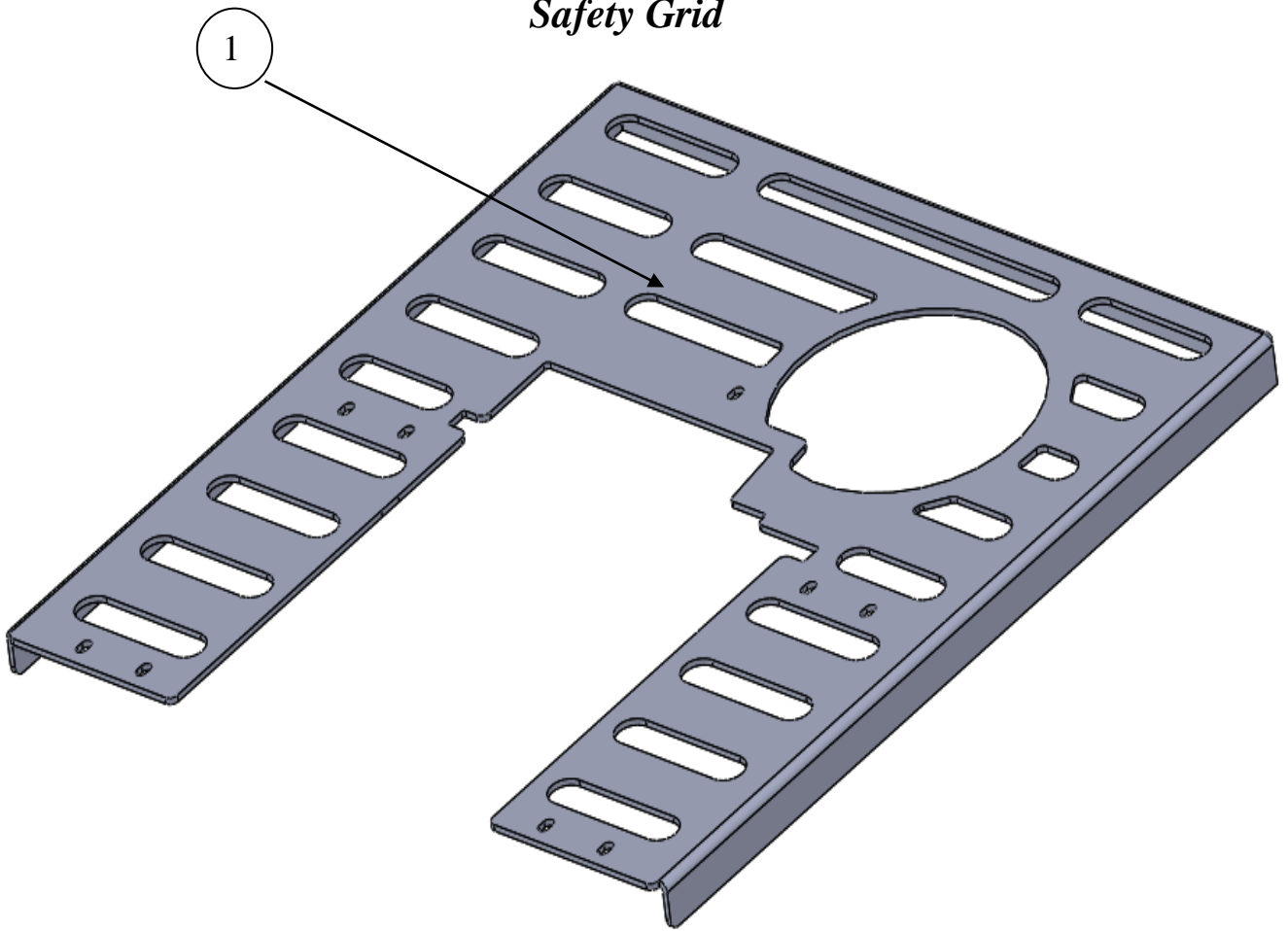

Part No.	Description
1	Steel frame

PTO Shafts

Part No.	Description
SP/003	Complete PTO shaft
1	Push pin
2	Shearpin hub (Splined)
3	Shearpin yoke hub
4	Shearbolt
5	Cross piece
6	Inner yoke
7	Roll pin
8	Tube Male section
9	Tube Female section
10	Outer yoke
11	End yoke
14	Covers for shaft
15	Retaining collar
16	Retaining collar

Note: - Only use shear bolts supplied by Hi-Spec Engineering Ltd.

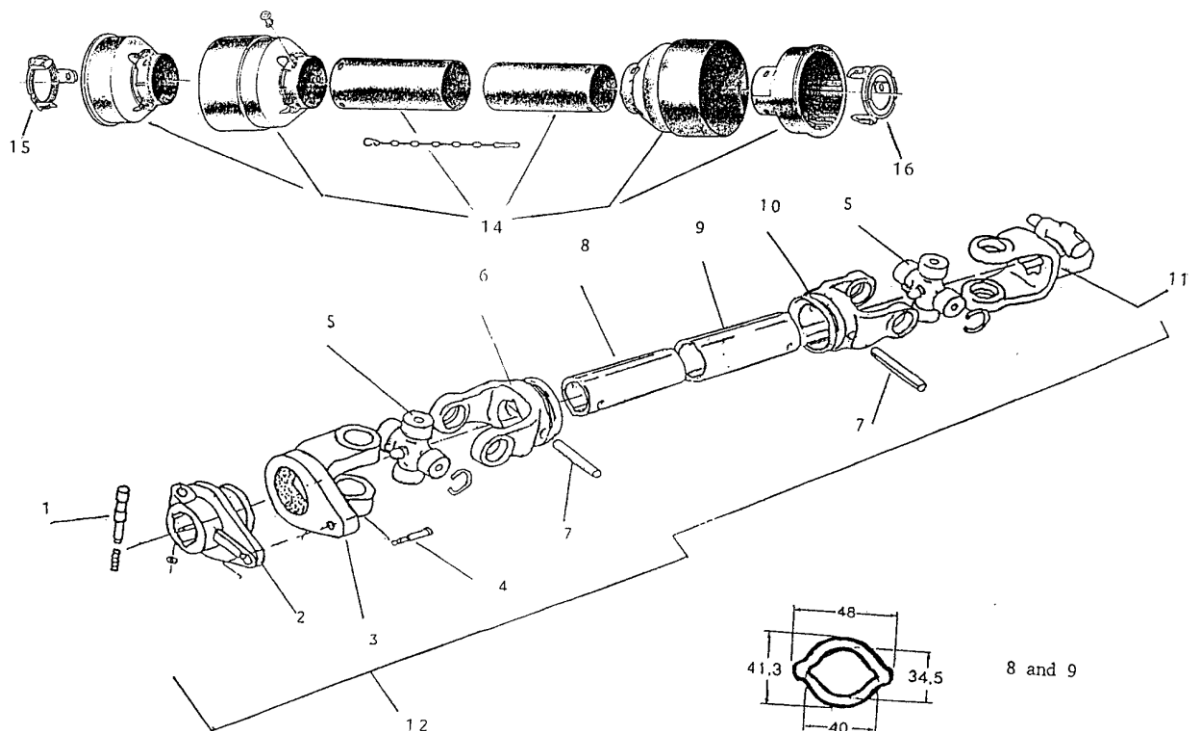



Sales and Service

Ireland

Head office

Hi-Spec Engineering Ltd., Station Rd, Bagenalstown, Co. Carlow, Ireland

Tel: - +353 59 9721929 Fax: - +353 59 9721980

Email: - sales@hispec.net or info@hispec.net

Sales

Contact: - Eoin Keane, Hi-Spec Engineering Ltd. Tel: - +353 87 2562963

Email: - eoin@hispec.net

Machine Servicing

Contact: - Michael Brennan, Hi-Spec Engineering Ltd. Tel: - +353 87 2403312

Spare Parts Store

Contact: Mike Nolan or Terence Byrne, Hi-Spec Engineering Ltd.

Tel: - +353 59 9721929 Fax: - +353 59 9721980

Email: - stores@hispec.net

U.K.

Sales

Wales & Southern England

Contact: - Edward Lewis, Hi-Spec Engineering Ltd. Tel: - +44 7876 452698

Email: - elewis@hispec.net

Scotland & Northern England

Contact: - Gordon Brodie, Hi-Spec Engineering Ltd. Tel: - +44 7799 905130

Email: - gordon@hispec.net

For spare parts

Contact: - Your local Hi-Spec dealer. If you require a contact name and number you can telephone head office and we would be glad to assist you.